

Guidelines for Selecting Housing for 2020-2021

These guidelines govern the housing selection process for the apartments at 44 Davis Square for the 2020-21 academic year. If you have any questions, please contact the Student Life Office on the first floor of HMSC. Office hours: Monday-Friday, 8:00 am-5:00 pm.

SEVEN STEPS TO REGISTER FOR HOUSING

HOUSING WILL BE DONE ONLINE THROUGH A SITE CALLED “eRezLife”. The procedures below MUST be followed to be eligible to select housing. Log into the housing site (<https://thiel.erezlife.com/>) to find detailed instructions and complete online steps.

Completing the more time-consuming steps early makes housing selection in March less stressful so students have more time to focus on preparing for finals.

1. **February 24-March 12:** Complete your housing application. There is **no cost** to complete this step. Also, **complete your application by March 12 and get \$50 off your housing deposit later if you give Student Accounts a printed copy of your application receipt.** Please see detailed instructions on the housing site at Resources > **Thiel Online Housing Selection Instructions.**
2. **March 13-19:** Set up Roommate Groups online. Detailed instructions are on the housing site at Resources > **Creating a Roommate Group.** A Facebook group chat has been set up for your convenience to help get to know the other students.
3. **March 13-19:** Complete your Housing Overview by reviewing your options and marking your favorites online. Detailed instructions are on the housing site at Resources > **Fast Favorites-Choosing Your Housing.**
4. **February 24-March 9:** Contact Student Accounts in Roth Hall. *Assure your account is in order so you can register for classes*
5. **March 9-17:** Meet with your advisor and register for classes
6. **BEFORE MAR 16:** Pay \$100 room deposit to Student Accounts Office (first floor of Roth Hall) by **March 16** (refundable until May 1, 2020). Deposit will be credited to your room fee for the fall semester. **Get \$50 off your deposit IF you provide Student Accounts with a printed copy of your application receipt showing a submission date of March 12, 2020 or earlier.**
7. **MAR 18-19:** Log in and **SELECT YOUR HOUSING!** *ALL of the above must be completed at least 24 hours before your selection date.* Detailed instructions for this last step are on the housing site at Resources > **Fast Favorites-Choosing Your Housing.** *Selection dates are listed on the next page.*

ONLINE HOUSING SELECTION TIMELINE

Room selection times are based on class year. Apartments that are not selected by graduate students on the dates listed may be opened for selection by undergraduates. **If your intended roommate selects the apartment ahead of you, he/she may choose you as a roommate and you will need to “confirm” that reservation online (watch your email for notifications).**

Login Times by Earned Credits

(CREDITS EARNED THROUGH DEC. 2019)

SLP Graduate Students	March 18-19
Current Seniors/“Super Seniors” (88+)	March 23 - 24
Current Juniors (58-87 credits)	March 25 - 26
Current Sophomores (26-57 credits)	March 30 - 31
Current Freshman and all others (25 or less)	April 1 – 2

HOUSING COST SUMMARY FOR 2020-2021

All costs are PER STUDENT

DAVIS SQUARE APARTMENTS			
Description	# of Occupants	Cost Per Person Per Year	Cost per Person Per Quarter
1-Bedroom	1	\$6,748.00	\$1,687.00
2-Bedroom	2	\$6,748.00	\$1,687.00

ROOM CHANGES

If a student's roommate does not move in for the semester or leaves within the first few weeks, the student will be matched with another roommate. If the student would prefer to choose their own roommate or keep their room as private, they must indicate their preference to the Housing Coordinator by submitting a change request form on the housing site. **Two-bedroom apartments must be occupied by at least 2 students.**

Room changes require prior approval by the Housing Coordinator and Residence Life staff. Unauthorized room changes will result in a fine of \$25.00 per day. If you have any questions regarding the above, contact the Office of Student Life or consult your Student Handbook for room change guidelines and fees.

***THIEL COLLEGE RESERVES THE RIGHT TO ASSIGN ROOMS AND ROOMMATES AND EXPECTS ALL STUDENTS TO RESPECT PROPERTY AND FURNISHINGS. IF YOU DO NOT CHOOSE A ROOMMATE, THE OFFICE OF STUDENT LIFE WILL ASSIST YOU IN FINDING A ROOMMATE.

MEDICAL ACCOMMODATIONS

Those with a medical need for a housing accommodation have first priority. All medical housing accommodation requests must be made through the Disability Resource Center (https://www.thiel.edu/campus_life/campus-resources/disability-services, Liza Schaefer - 724-589-2063).

WHAT ARE MY HOUSING OPTIONS?

Thiel College has blocked off the apartments at 44 Davis Square for our graduate students to select if they choose to do so during the housing lottery. Roommate groups must contain at least one student per bedroom to reserve an apartment.

Apartments include: Furnished living room with couch and end/coffee table(s), full kitchen with stove, refrigerator, table & chairs (utensils, plates, etc., are not included), a full bathroom, bedroom(s) with a loftable bed, dresser, desk and chair for each student. Each apartment also includes window treatments (mini blinds) and an air conditioner. There are also several closet spaces and a pantry.

Note: You must fill the minimum number of assigned beds in an apartment or you risk losing the space. Be sure all roommate groups are set up and approved online ahead of time to assure selections are secured.

Students seeking apartments who do not manage to obtain the space they want during online selection should email the Housing Coordinator (dmazur@thiel.edu) for assistance before 8 AM on March 20.

ADDITIONAL INFORMATION

Contact Diana Mazur at dmazur@thiel.edu , or Bob Phillips at rphillips@thiel.edu . Office hours are 8:00-5:00. You may also refer to your Student Handbook.

Sample Floor Plans (all levels have the same layout):

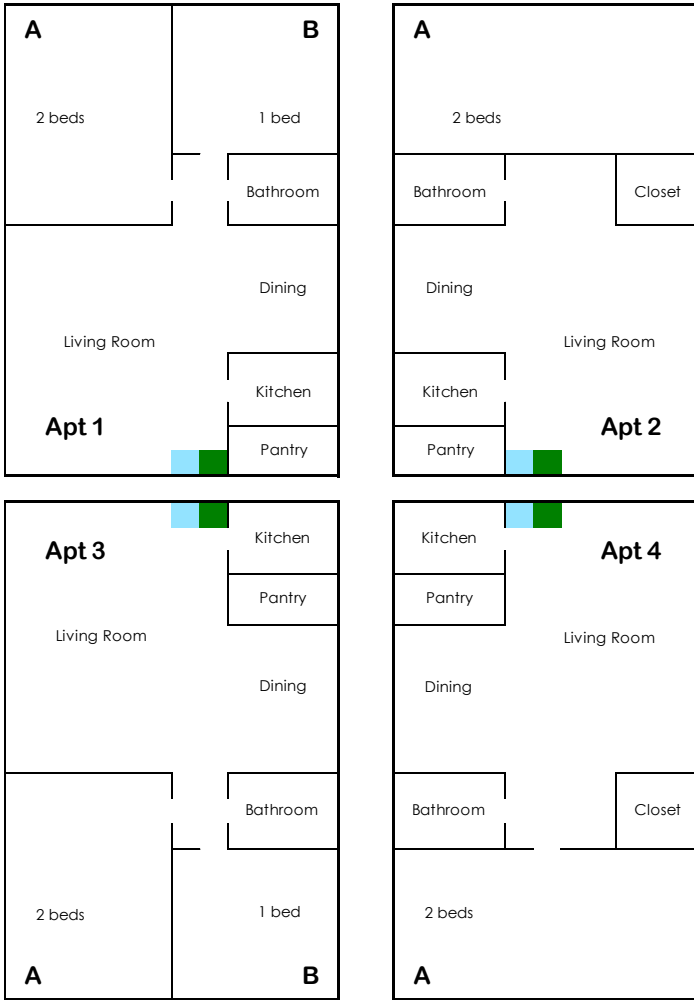

Room Characteristics Legend

- Air Conditioned
- Animal Approved... (Animals are not permitted on campus unless approved through the Disability Resource Center)
- Efficiency
- Gender Inclusive
- Handicap Accessible
- Hearing Impaired
- Honors Housing
- Premium Housing
- Resident Assistant



THIEL
COLLEGE